



PRODUCT FEATURES

- 82 oz. scoop protected by H-GUARD Plus Antimicrobial Agent
- Seamless polyethylene bin liner for sanitary storage
- Sealed door gasket reduces risk of airborne bacteria
- Ice storage capacity from 1148 lbs. to 1605 lbs.
- Easy cleaning and long-lasting attractive appearance
- Foamed-in-place polyurethane insulation, in all bin walls and bottom, which provides maximum ice preservation
- New baffle design increases ice accessibility by 30% View windows provide instant inspection and thermal break
- Pouch style insulated door prevents condensation while providing maximum access and minimal spillage
- All bins include Universal Top Kit – note application guide to verify fit
- 6" adjustable stainless-steel legs



TECHNICAL DRAWING

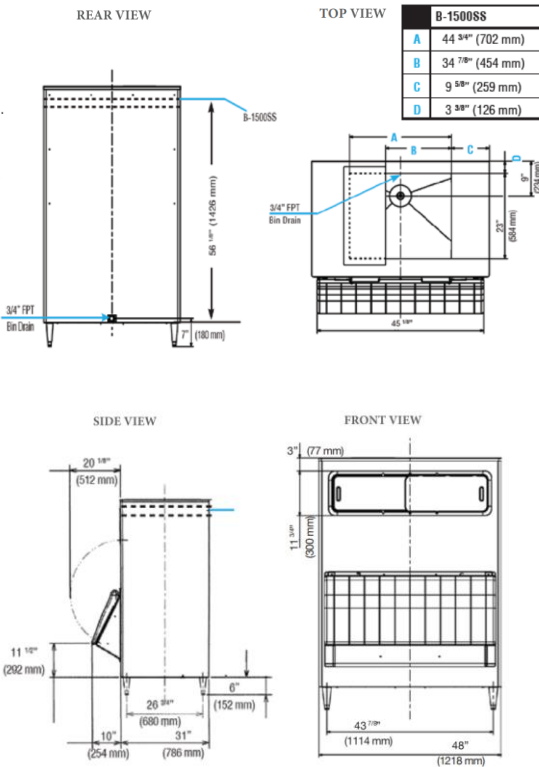

PRODUCT SPECIFICATION

Storage Capacity	Maximum 680kg
Exterior Dimensions	1523mm(W)x 1040mm(D)x 1578mm(H) *150mm legs included
Weight Net/Gross (kg)	163/187



For free 6 month extended warranty, register online within 4 weeks of purchase date. hoshizaki.com.au

